

# Assembly Instructions

## Cryaxx Series Coaxial Valves

Version Nov 2009

---

### Assemble piston rings

- Place piston ring in front bearing plate

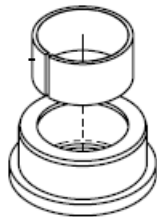
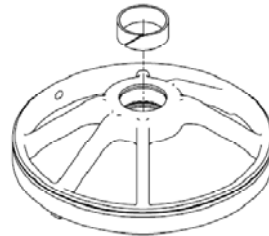

- Place piston ring in spindle ball bearing (3x)

- 
- Place piston ring in back bearing plate
  - Insert cylinder head screws

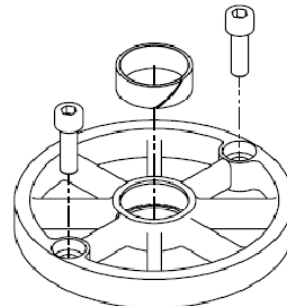

---

### Assemble spindle ball bearing

- Insert upper and lower spindle ball bearing

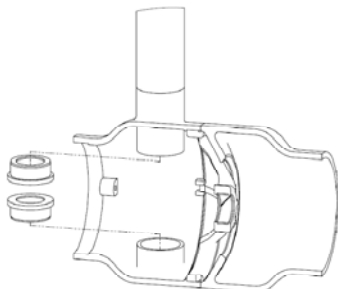

### Assemble bevel

- Insert fitting key in bevel
- Turn bevel with plane side 90° counter-clockwise
- Place bevel in valve body
- Pre-assemble shaft, assemble clamping ring, mount pin and spindle ball bearing

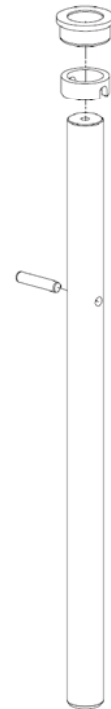
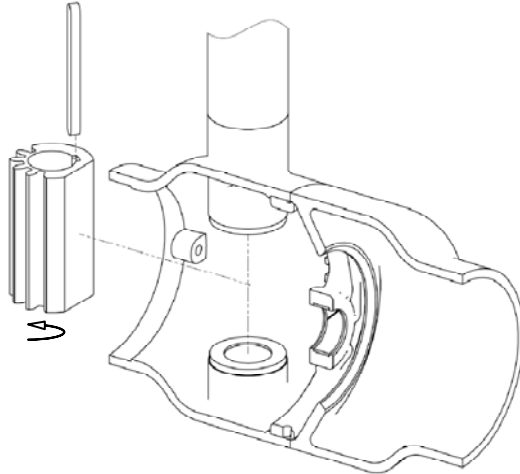

### Assemble gear shaft

- Bypass gear shaft at bevel
- Turn back plane side of bevel 90°
- Adjust bevel and gear shaft
- Place back bearing plate on gear shaft
- Tighten screws at torque spec.

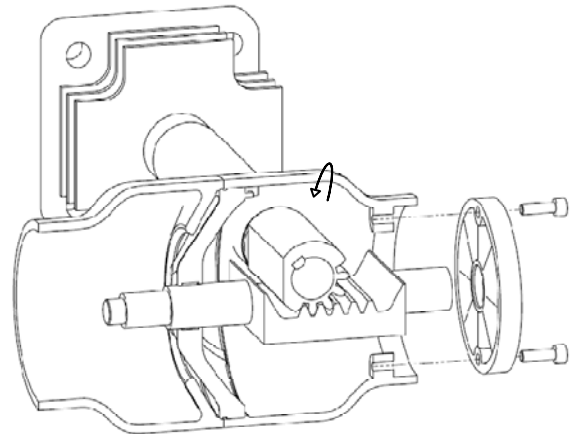
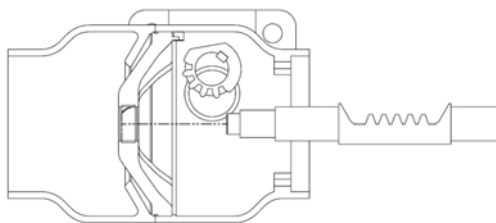

### Assemble shaft

- Assemble pre-assembled shaft in valve body while passing through the spindle ball bearing
- Push shaft in bevel up to block

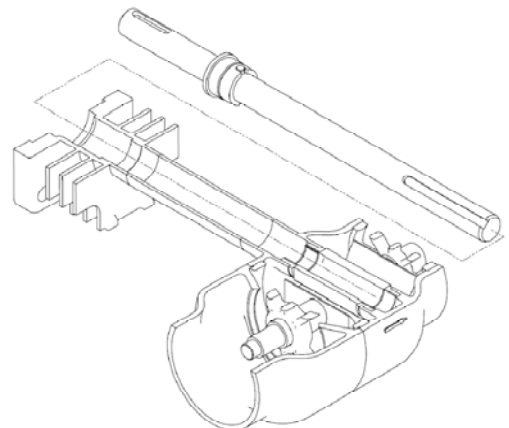

### Assemble cone

- Screw cone with sealing onto gear shaft and tighten at torque spec.

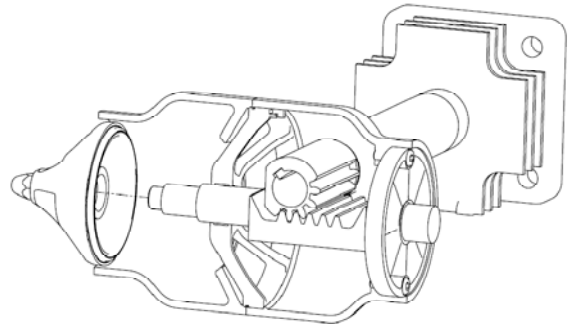

### Assemble gasket package

- Place support ring with collar
- Insert pressure ring
- Screw roof collar ring and tighten hand tight

